

PERMIT
CITY OF NAPOLEON, OHIO - BUILDING DEPARTMENT
 255 West Riverview Avenue, Napoleon, Ohio 43545 - (419) 592-4010

Permit No. <u>3648</u> Issued <u>08/21/95</u>		FEES	BASE	PLUS	TOTAL
Job Location <u>975 Westmont Ave.</u>	<input type="checkbox"/>	Building	\$	\$	\$
Lot _____	<input type="checkbox"/>	Electrical	\$	\$	\$
Issued by <u>Brent N. Damman</u>	<input checked="" type="checkbox"/>	Plumbing	\$ 9.00	\$	\$ 9.00
Owner <u>Don Collier 592-2621</u>	<input type="checkbox"/>	Mechanical	\$	\$	\$
Address <u>975 Westmont Ave.</u>	<input type="checkbox"/>	Demolition	\$	\$	\$
Agent <u>Jerry Glanz 599-4103</u>	<input type="checkbox"/>	Zoning	\$	\$	\$
Address <u>6 Lakeview Dr. Napoleon, OH</u>	<input type="checkbox"/>	Sign	\$	\$	\$
Use Type - Residential <u>X</u>	<input type="checkbox"/>	Water Tap	\$	\$	\$
Other - Describe _____	<input type="checkbox"/>	Sew. Insp.	\$	\$	\$
No. Dwelling Units _____	<input type="checkbox"/>	Sewer Tap	\$	\$	\$
New _____ Replacement <u>X</u>	<input type="checkbox"/>	Temp. Water	\$	\$	\$
Add'n. _____ Alter _____ Remodel _____	<input type="checkbox"/>	Temp. Elec.	\$	\$	\$
Fixed Occupancy _____	TOTAL FEES.....\$ 9.00				
Change of Occupancy _____	LESS FEES PAID.....\$ 9.00				
Estimated Cost \$ <u>500.00</u>	BALANCE DUE.....\$ -0-				

ZONING INFORMATION

district	lot dimensions	area	front yd	side yd	rear yd
max hgt	no pkg spaces	no ldg spaces	max cover	petition or appeal req'd	date appr

WORK INFORMATION

Size: Length _____ Width _____ Stories _____ Ground Floor Area _____
 Height _____ Building Volume (for Demo. Permit) _____

Electrical: _____
 Plumbing: Replace plumbing & service line.
 Mechanical: _____
 Additional Information: _____

PAID
 AUG 21 1995
 CITY OF NAPOLEON

Date 8-21-95 Applicant Signature Joan M. Collier

APPLICATION FOR
 Residential, Building, Electrical, Plumbing, Mechanical, and Demolition Permit
FROM - The City of Napoleon, Ohio, Building Department
 255 West Riverview Avenue; P.O. Box 151; Napoleon, Ohio 43545 - Telephone (419) 592-4010

ENTRY NO. _____

PERMIT NO. 3648 ISSUED 8-21-95

JOB LOCATION 975 Westmont

LOT _____
 (Subdivision or Legal Description)

ISSUED BY BND
 (Building Official)

OWNER Don Collier PHONE 592-2621

ADDRESS 975 Westmont Nap

AGENT Jerry Glanz PHONE 599 4103

ADDRESS 6 LeKerical Dr Nap

USE: Residential () Commercial () Industrial
 () Other _____

WORK: () New () Addition Replacement () Remodel

ESTIMATED COST = \$ 500.00

	Base	Plus	Total
() Building	\$ _____	\$ _____	\$ _____
() Electrical	\$ _____	\$ _____	\$ _____
<input checked="" type="checkbox"/> Plumbing	\$ <u>9.00</u>	\$ _____	\$ <u>9.00</u>
() Mechanical	\$ _____	\$ _____	\$ _____
() Demolition	\$ _____	\$ _____	\$ _____
() Zoning	\$ _____	\$ _____	\$ _____
() Sign	\$ _____	\$ _____	\$ _____
() Water Tap	\$ _____	\$ _____	\$ _____
() Sewer Tap	\$ _____	\$ _____	\$ _____
() Temp Water	\$ _____	\$ _____	\$ _____
() Temp Elec.	\$ _____	\$ _____	\$ _____

Additional Structure _____ Hours _____
 Plan Review: Electric _____ Hours _____

TOTAL FEES	\$ <u>9.00</u>
Less Fees Paid	\$ <u>9.00</u>
BALANCE DUE	\$ <u>-0-</u>

ZONING INFORMATION

District	Lot Dimensions	Area	Front Yard	Side Yard	Rear Yard
----------	----------------	------	------------	-----------	-----------

Max Height	No. Pkg. Spaces	No. Ldg. Spaces	Max Cover	Petition or Appeal Required-Date
------------	-----------------	-----------------	-----------	----------------------------------

WORK INFORMATION

Building: Ground Floor Area _____ sq. ft. Basement Floor Area _____ sq. ft.

Garage Floor Area _____ sq. ft. 2nd Floor Area _____ sq. ft. Other _____

Size: Length _____ Width _____ Stories _____ Height _____

Building Volume (for Demolition Permit) _____ cubic feet

Description of Work: Replace plumbing & sewer lines

PAID ft.
 AUG 21 1995
 CITY OF NAPOLEON

ELECTRICAL: Contractor _____ Phone _____
Address _____ ESTIMATED COST = \$ _____

Type of Work: ()New ()Service Change ()Rewiring ()Add'l Wiring TEMPORARY ELEC. REQUIRED - ()Yes ()No
Size of Service _____ Underground _____ Overhead _____ Number of New Circuits _____

Description of Work: _____

PLUMBING: Contractor _____ Phone _____
Address _____ ESTIMATED COST = \$ _____

WATER TAP REQUIRED - ()Yes ()No Size _____ Type of Pipe _____ Water Dist. Pipe _____

SANITARY SEWER TAP REQUIRED - ()Yes ()No Size _____ Type of Pipe _____ Dr. Waste Vt. Pipe _____

STREET SEWER TAP REQUIRED - ()Yes ()No Type of Pipe _____ STREET TO BE OPENED - ()Yes ()No

Main Building Drain Size = _____ Main Vent Pipe Size = _____

LIST NUMBER OF PLUMBING FIXTURES BELOW:

Water Closets = _____ Bathtubs = _____ Showers = _____ Lavatories = _____ Kitchen Sinks = _____ Disposal = _____
Clothes Washer = _____ Floor Drains = _____ Dishwasher = _____ Other _____ Total = _____

Description of Work: _____

MECHANICAL: Contractor _____ Phone _____
Address _____ ESTIMATED COST = \$ _____

HEATING SYSTEM - ()Forced Air ()Gravity ()Hot Water ()Steam ()Unit Heaters ()Radiant ()Baseboard

TYPE OF FUEL - ()Electric ()Natural Gas ()Propane ()Wood ()Coal ()Solar ()Geothermal Other _____

NUMBER OF HEAT ZONES = _____ HOT WATER - ()One (1) Pipe ()Two (2) Pipes ()Series Loop

ELECTRIC HEAT - Number of Circuits _____ Number of Furnaces _____ Number of Hot Air Runs _____

Number of Hot Water Radiators _____ Total Heat Loss _____ Rated Capacity of Furnace/Boiler _____

LOCATION OF HEATING UNITS - ()Crawl Space ()Floor Level ()Attic ()Suspended ()Roof ()Outside

Description of Work: _____

DRAWINGS REQUIRED: All applications must be accompanied by two (2) complete sets of Drawings including Site Plans, Foundation Plans, Floor Plans, Structural Framing Plans, Exterior Elevations, Section and Details, Stair Details, Electrical Layout, Plumbing Isometric, Heating Layout, etc. All Plans shall be drawn to scale, show all existing structure on the Site Plans, and show electric panel and furnace locations.

READ AND SIGN BELOW: The undersigned hereby makes application for a Permit for all work described herein and agrees to complete the work in strict accordance with all applicable provisions of the current edition of the C.A.B.O. Building Code, the Napoleon Building and Zoning Codes, the Napoleon Engineering Department Rules and Regulations, Standard Specifications and other pertinent sections of the Napoleon Code of Ordinances.

Signature of Applicant _____ Date _____

Jerry Glanz

6-19-95



c/k Glenwood

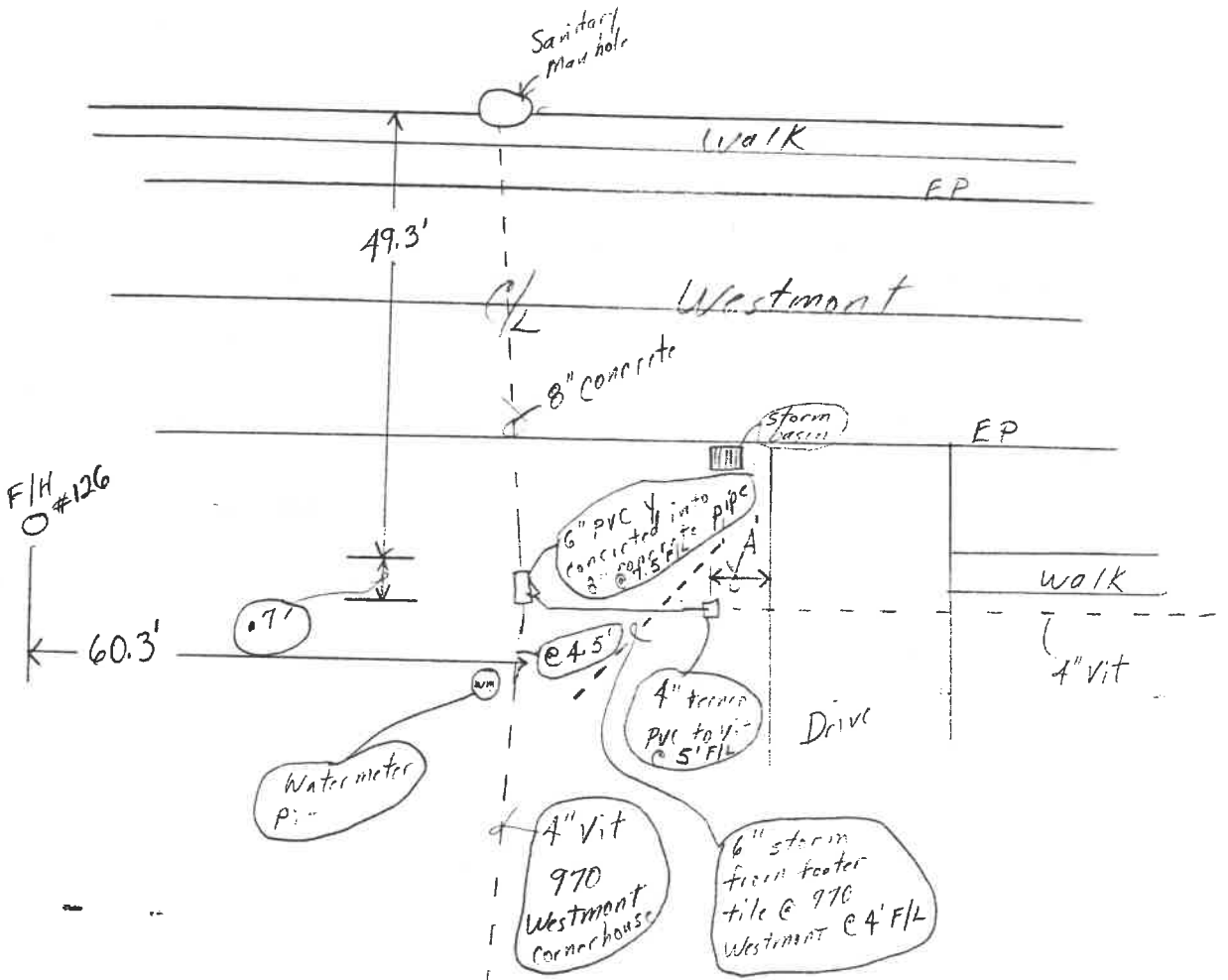

975 Westmont

JNA

SEWER TAPPING PERMIT

Issued by

The City of Napoleon Engineering Dept.

255 West Riverview Ave. Napoleon, Ohio 43545 Pn. 592-4010

Entry No. _____

Permit No. _____ Issued 8-21-95 Build. Permit No. _____

Job Location 975 Westmont _____

Lot _____

Issued By _____ sub div. or legal disc.

Owner Don Collier _____ Pn. _____

Address 975 Westmont _____

Agent Jerry Glanz _____ Pn. _____

Address 6 Lakeview Dr. _____

Permit Fee \$ _____

Street Bond \$ _____

Date Paid _____

for office use only

WORK INFORMATION

Sewer line replacement

Sanitary Sewer Tap _____ Size of Tap _____ Size and Type of Sewer _____ Street to be Opened _____
yes no yes no

Storm Sewer Tap _____ Size of Tap _____ Size and Type of Sewer _____ Street to be Opened _____
yes no yes no

Street opening Agreement Approval Date _____ Opening Bond Fee (Set by Engineer) _____

READ AND SIGN BELOW; The undersigned hereby agrees complete the work described above and to make use of said sewers only as allowed by and in strict accordance with all applicable provisions of The Napoleon Engineering Dept. Rules and Regulations, The Napoleon Standard Specification for Water Main, Sanitary Sewer and Storm Sewer Construction and other Pertinent Sections of the Napoleon Code of Ordinances.

Date 8-21-95 Signature of Applicant Joan M. Collier

Permit not valid without signature

INSPECTION RECORD _____ to be completed by the Field Inspector

Date Inspection is made _____ Size and Type of Sewer _____

Location _____ Depth _____ Type of Test _____ Additional Information _____

Date _____ Inspected By _____

signature of inspector

Sketch Of Installation on Back or Attached

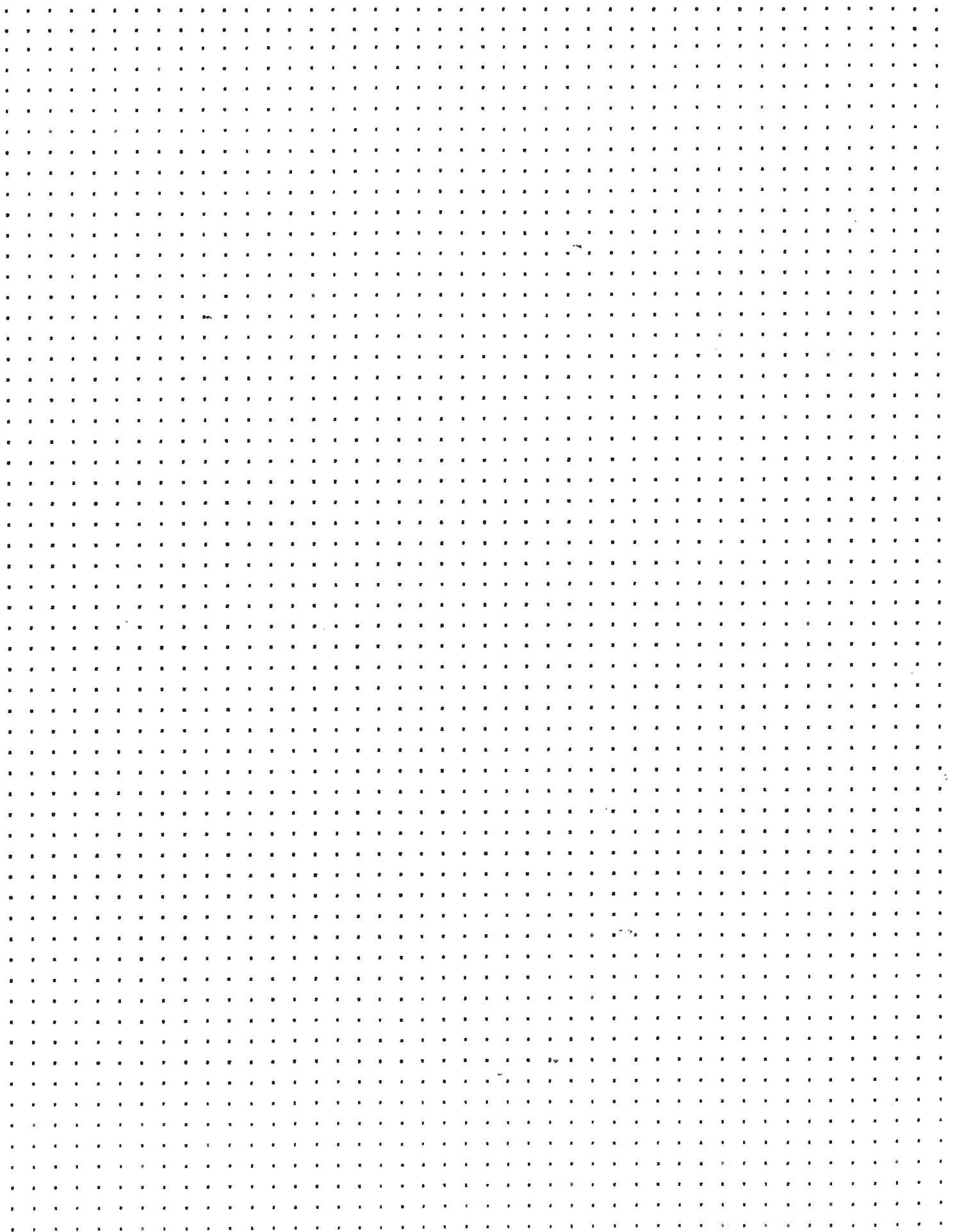

975 Westmont
Jerry Glang
8-31-95

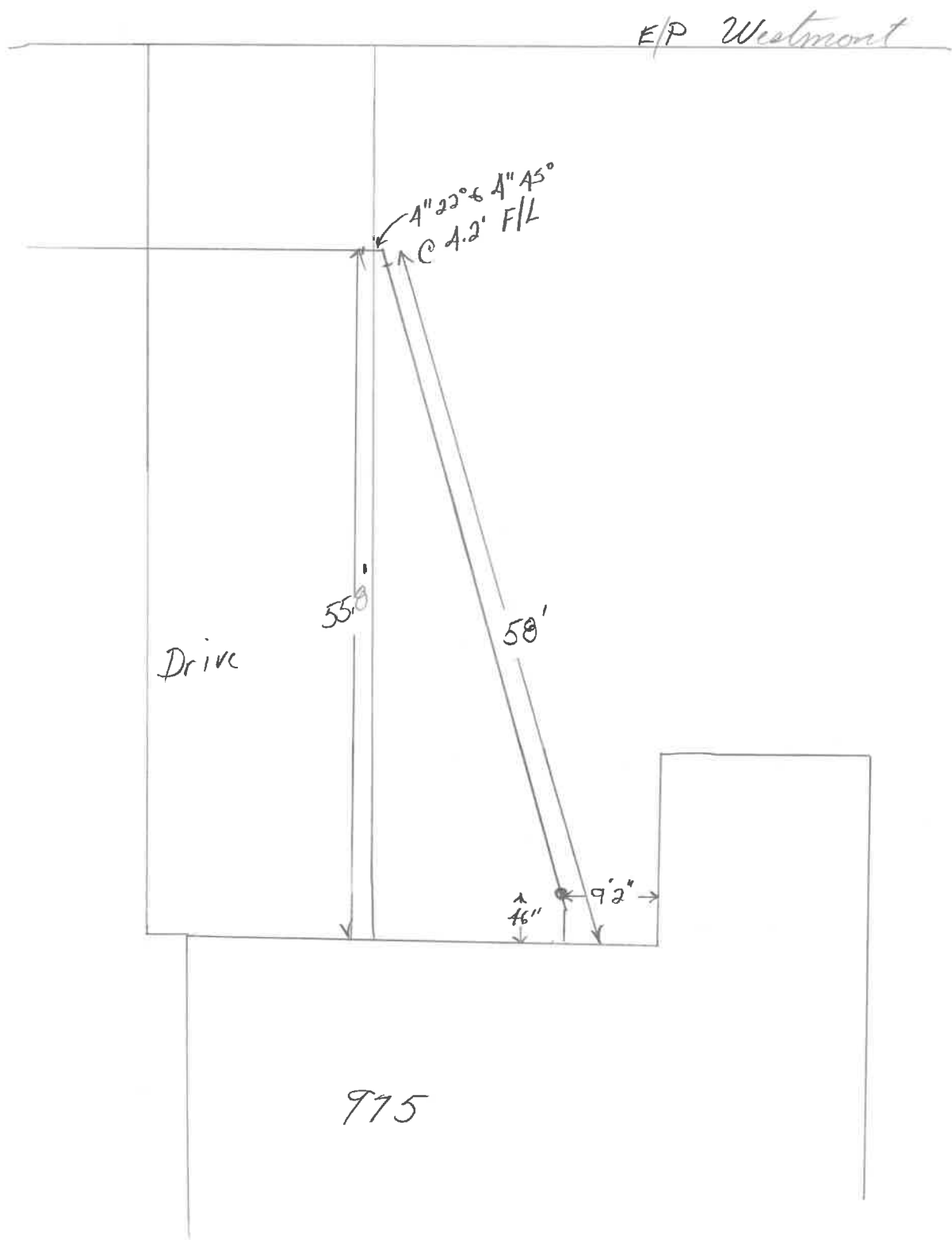

Mort Cordes
9-18-95
New sewer line

